

LIFTEK
SUPPLIED BY **SHS**

SELF DRIVE
ELECTRIC
PALLET TRUCK

1500 KG

PRODUCT CODE

25248



- ✓ Great first step into automation
- ✓ Handles repetitive routes with ease
- ✓ Seamlessly switch between manual and autonomous operation
- ✓ Plug-in battery design
- ✓ Keypad option for greater operation convenience
- ✓ 2D visual navigation
- ✓ Maximum personal safety protection

Streamline pallet runs, production flow, eliminate repetitive walking, and optimise high-frequency tasks. From consistent A-B loops with manual interaction to seamless integration with automatic loading and unloading, the LIFTEK® SELF DRIVE PALLET TRUCK frees your team for higher-value work.

SHS
HANDLING SOLUTIONS

0800 619 0800

SALES@SHS-HANDLING.COM

SHSHANDLING
SOLUTIONS
.COM



SHS HANDLING SOLUTIONS LTD, ELEVATION HOUSE, UNIT C,
TINGEWICK ROAD INDUSTRIAL PARK, BUCKINGHAM, MK18 1SU



FEATURES

AUTOMATED ROUTE: A-B-C...-A LOOP WITH MANUAL LOADING AND UNLOADING

Automated route example transports pallets along the loop continuously. Workers are able to load or unload goods manually on the way. Pauses on pre-programmed work stations.

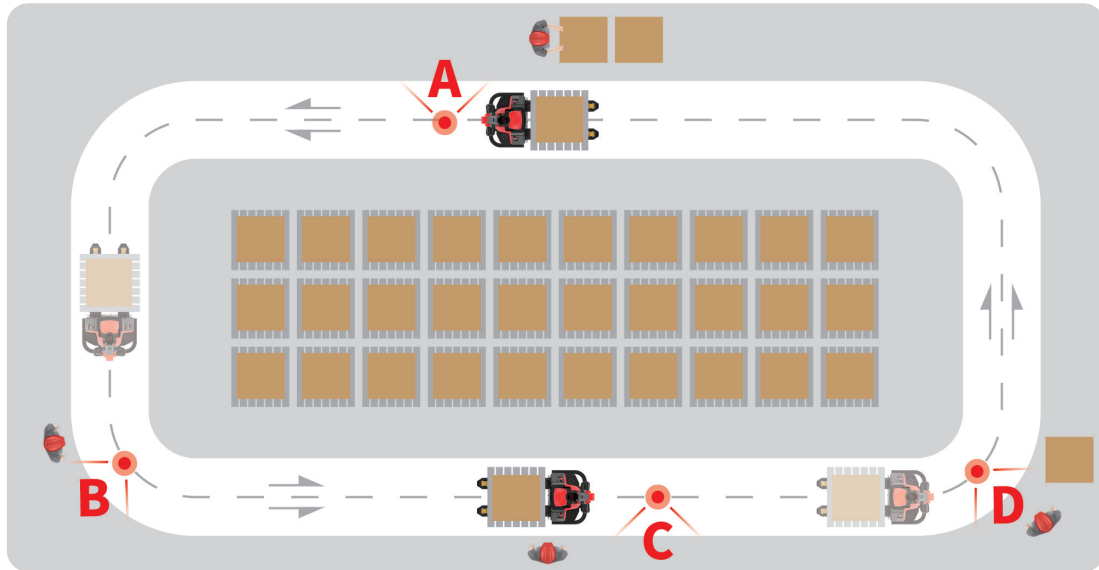

AUTOMATED ROUTE: A-B-A WITH AUTOMATIC UNLOADING

This route example starts with manual loading and unloads pallets automatically in the storage area or production. It requires minimum involvement of workers and delivers high process efficiency where transportation tasks need to be repeated permanently.

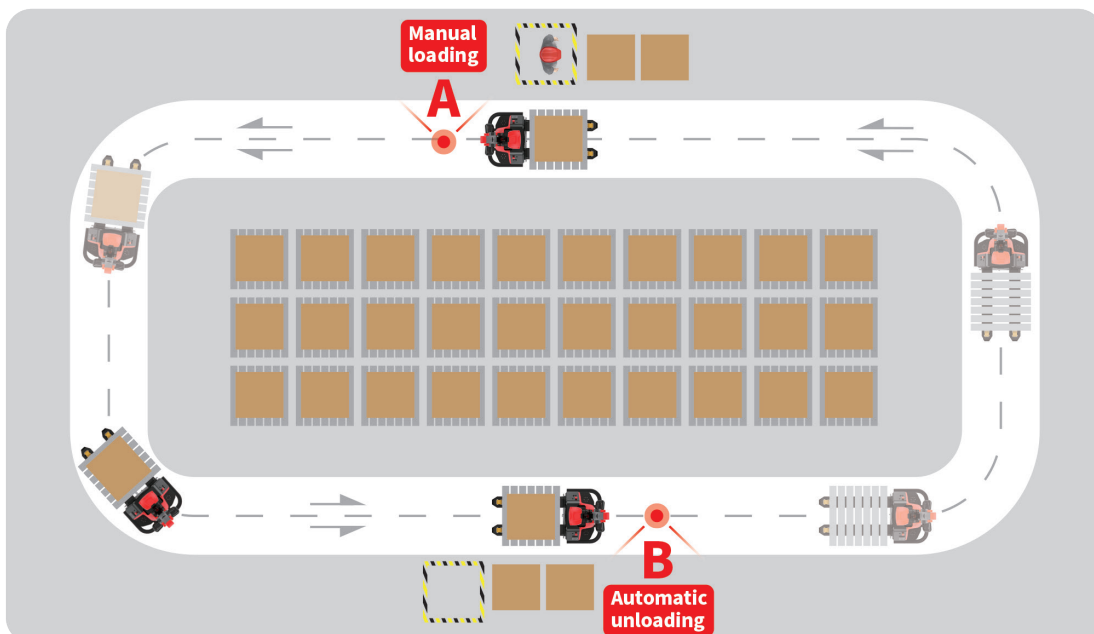



FEATURES

YOUR BEST CO-WORKER

You can operate the LIFTEK® SELF-DRIVE PALLET TRUCK as an autonomous mobile robot as well as an electric pallet truck. Switch between manual and automatic operation by the push of a button.



STAND ALONE INSTALLATION

The LIFTEK® SELF DRIVE PALLET TRUCK is easy to set up for various applications without IT knowledge or specialised hardware and software.

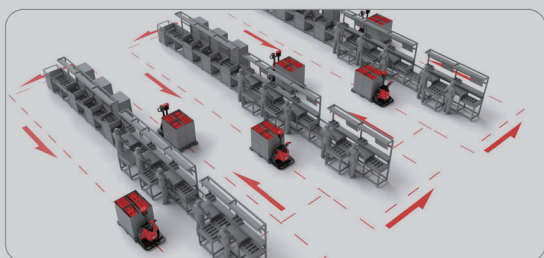

FLEXIBLE TO CHANGE TASKS

The LIFTEK® SELF DRIVE PALLET TRUCK offers route settings and transportation task monitoring via bluetooth. Add new routes and stations quickly on the keypad (or a mobile phone).

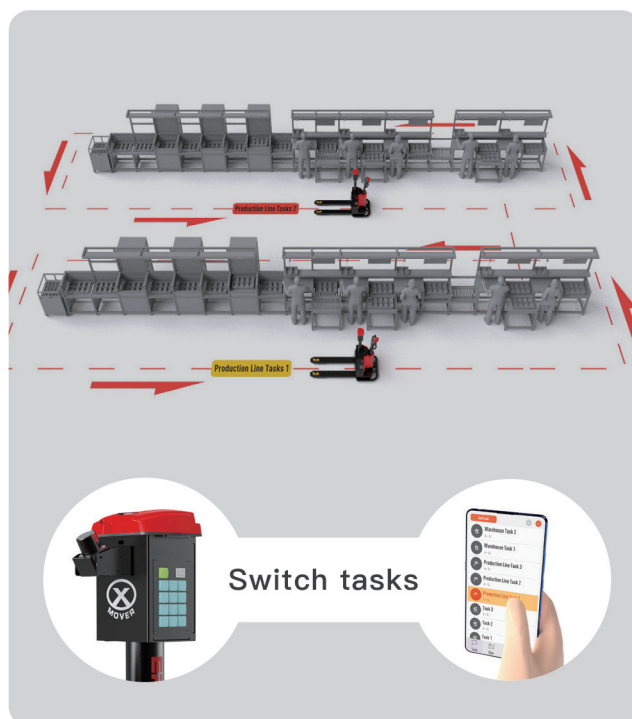



FEATURES

PLUG-IN BATTERY DESIGN



The LIFTEK® SELF DRIVE PALLET TRUCK features plug-in battery design with a 24V/60Ah Li-ion battery. This maximises uptime and provides high availability and flexibility.



MAXIMUM PERSONAL SAFETY PROTECTION



The LIFTEK® SELF DRIVE PALLET TRUCK is equipped with Bumper strips and Lidar detectors that prevent the truck from collision.

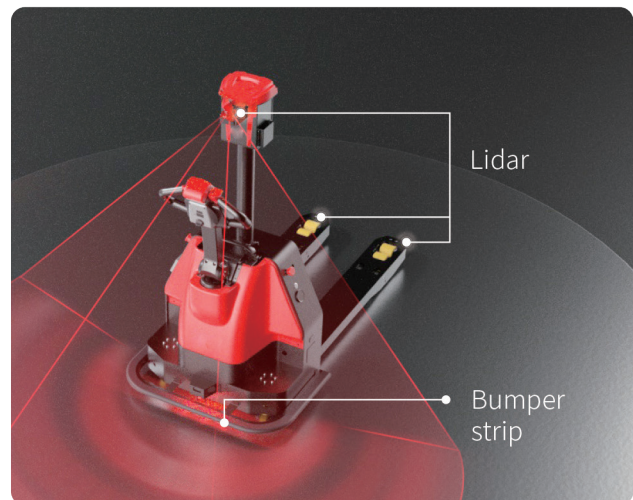

KEYPAD OPTION FOR GREATER OPERATION CONVENIENCE



The LIFTEK® SELF DRIVE PALLET TRUCK offers an optional keypad which can be directly connected to the truck. After binding all tasks to the keypad, the operator can quickly start the truck, deliver transportation tasks and easily switch between different tasks on the go. This user-friendly keypad can replace the phone, increasing convenience on a daily basis.



2D VISUAL NAVIGATION



The LIFTEK® SELF DRIVE PALLET TRUCKS' visual navigation technology provides highly stable and adaptable navigation. With absolute positioning, with random labeling and visual navigation, the vehicle knows its position at all times to proceed its path.

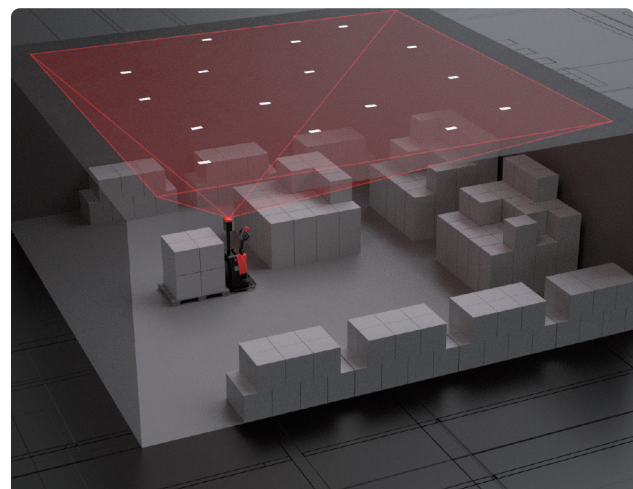



PALLET MOVER ACROSS FACTORY & WAREHOUSE 1.5T

Distinguishing mark	1.1	Manufacturer			LIFTEK®
	1.2	Model			25248
	1.3	Drive			Electric
	1.4	Operator type			Pedestrian
	1.5	Load capacity	Q	kg	1500
	1.6	Load centre distance	c	mm	600
	1.8	Load distance, centre of drive axle to fork	x	mm	980
	1.9	Wheelbase	y	mm	1210
Service weight	2.1	Service weight		kg	335
	2.2	Axel loading, laden front/rear		kg	1150/510
	2.3	Axel loading, unladen front/rear		kg	120/40
Tyres/Chassis	3.1	Tyre type			PU
	3.2.1	Tyre size, front		mm	210/94
	3.3.1	Tyre size, rear		mm	85*70
	3.4	Additional wheels (castor wheels)		mm	74*30
	3.5	Wheels, number front/rear (x=drive wheels)		mm	1,2/4
	3.6.1	Tread width, front	b10	mm	504
	3.7.1	Tread width, rear	b11	mm	430
Dimensions	4.4	Lift height	h3	mm	95
	4.9	Height of tiller handle in position min/max	h14	mm	-
	4.15	Lowered height	h13	mm	90
	4.19	Overall length	l1	mm	1695
	4.20	Length to face of forks	l2	mm	545
	4.21	Overall width	b1/b2	mm	842
	4.22	Fork dimensions	s/e/l	mm	55x170x1220
	4.25	Distance between fork-arms	b5	mm	540
	4.32	Ground clearance, centre of wheelbase	m2	mm	30
	4.34.1	Aisle width for pallets 1000x1200 crossways	Ast	mm	2300
	4.34.2	Aisle width for pallets 800x1200 lengthways	Ast	mm	2160
Performance data	4.35	Turning radius	Wa	mm	1500
	5.1	Travel speed, laden/unladen		m/s	0.9/1
	5.2	Lifting speed, laden/unladen		m/s	0.017/0.02
	5.3	Lowering speed, laden/unladen		m/s	0.09/0.06
	5.8	Max. gradeability, laden/unladen		%	6/16
Electric-engine	5.10	Service break			Electromagnetic
	6.1	Drive motor rating S2 60 min		kW	0.9
	6.2	Lift motor rating S3 15%		kW	0.8
	6.4	Battery voltage / nominal capacity		V/Ah	24/60
	6.5	Battery weight		kg	14
Additional data	8.1	Type of drive control			AC
	10.5	Steering design			Electric
	10.7	Sound pressure level at the other drivers ear		dB(A)	<70
	10.11	Indoor/Outdoor			Indoor
	10.12	Safety notification			Hom
	10.13	Safety protection			Physical bumper strip Lidar
	10.14	Positioning			Emergency stop button 2D visual navigation
	10.15	Parking accuracy		mm	±20
	10.16	Navigation accuracy		mm	±20
	10.17	Battery type			Li-ion battery

If there are improvements of technical parameters or configurations, no further action will be given. The diagram shown may contain non-standard configurations.



PALLET MOVER ACROSS FACTORY & WAREHOUSE 1.5T

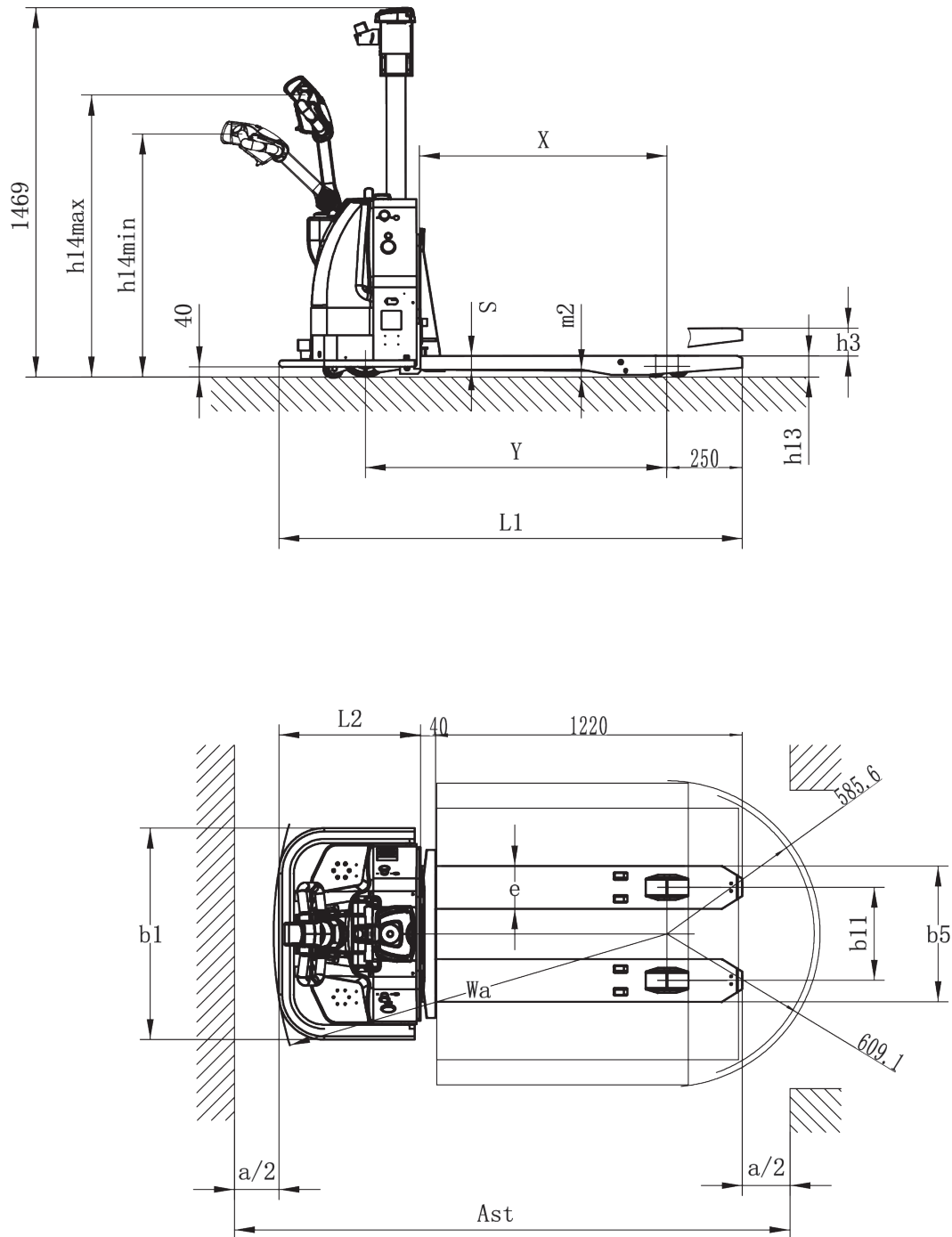

AT SHS, WE HELP COMPANIES MOVE GOODS SAFELY AND EFFICIENTLY BY DESIGNING, SUPPLYING, AND MAINTAINING MATERIALS HANDLING EQUIPMENT.

SHS
HANDLING SOLUTIONS

☎ 0800 619 0800
✉ SALES@SHS-HANDLING.COM

SHS HANDLING
SOLUTIONS
.COM

📍 SHS HANDLING SOLUTIONS LTD, ELEVATION HOUSE, UNIT C,
TINGEWICK ROAD INDUSTRIAL PARK, BUCKINGHAM, MK18 1SU